

SETU ATA211G

VoIP-FXS-GSM Adaptor



User Card

Know Your SETU ATA211G

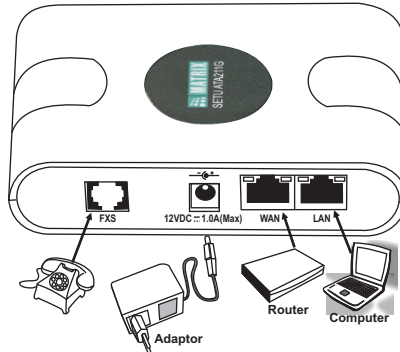

Making/Receiving Calls

Making Calls (Note 6)

- Go OFF-Hook.
- Dial the Number.
- Talk.

Making Calls using Speed Dialing (Note 1)

- Go OFF-Hook.
- Dial #9-Speed Dialing Index Number.
- Talk.

Making New Calls (Note 4, 6)

- Active Call.
- Dial #81.
- Dial the Number after the dial tone.
- Talk.

Disconnect the Call (Note 4)

- Active Call.
- Dial #82.
- Error Tone.

Making Calls using-Mobile (Note 5, 6)

- Go OFF-Hook.
- Dial #83.
- Dial the Number.
- Talk.

Making Calls using-SIP1 (Note 5, 6)

- Go OFF-Hook.
- Dial #84.
- Dial the Number.
- Talk.

Making Calls using-SIP2 (Note 5, 6)

- Go OFF-Hook.
- Dial #85.
- Dial the Number.
- Talk.

Making Calls using-SIP3 (Note 5, 6)

- Go OFF-Hook.
- Dial #86.
- Dial the Number.
- Talk.

Making Peer-to-Peer Calls

- Go OFF-Hook.
- Dial the Number stored in P2P table.
- Talk.

Receiving Calls

- Ring for IC Call.
- Go OFF-Hook.
- Talk.

Managing Calls

Call Hold (Note 5)

- Active call.
- Dial Flash to hold the call.
- Dial Flash again to Retrieve the held call.

Making Second Call (Note 5)

- Active Call.
- Dial Flash-Number String.

Call Waiting (Note 5)

When you have one active call and one waiting call

- Dial Flash-#3 to Reject waiting call.
- Dial Flash-#4 to Hold current call and answer waiting call.
- Dial Flash-#5 to Disconnect current call and answer waiting call.

Call Transfer (Note 5)

When you have one active call

- Dial Flash-#6-Number String for Blind Call Transfer.
- Dial Flash-Number String-Speech-Dial Flash-#7 for Attended Call Transfer.

3-Party Conference (Note 5)

- Speech with Party 1.
- Dial Flash.
- Dial number of Party 2.
- Speech with Party 2.
- Dial Flash-#2 to conduct Conference.
- Dial Flash-#4 to toggle from Conference while in Conference.

Call Toggle (Note 5)

- Dial Flash-#4 when you have one active call and one held call.

Other Features

Programming Mode (Note 5)

- To enter programming mode for Admin*
- Dial #19-Admin Password (default 1234).
- To enter programming mode for User*
- Dial #18-User Password (default 1234).
- To exit from programming mode*
- Dial 0.

Call Forward (CF) (Note 2, 5)

- To set Call Forward-Unconditional*
- Dial 52-1-#*.
- To cancel Call Forward-Unconditional*
- Dial 52-0-#*.
- To program CF-Unconditional Number*
- Dial 51-Destination Number-#*.
-
- To set Call Forward-When Busy*
- Dial 54-1-#*.
- To cancel Call Forward-When Busy*
- Dial 54-0-#*.
- To program CF-When Busy Number*
- Dial 53-Destination Number-#*.
-
- To set Call Forward-When No Reply*
- Dial 56-1-#*.
- To cancel Call Forward-When No Reply*
- Dial 56-0-#*.
- To program CF-When No Reply Number*
- Dial 55-Destination Number-#*.
- To program CF-No Reply Timer/CF-Timer*
- Dial 57-Timer-#*

Do Not Disturb (DND) (Note 2, 5)

- To set DND*
- Dial 61-1-#*.
- To cancel DND*
- Dial 61-0-#*.

Caller ID (Note 2, 3)

- To send Caller ID*
- Dial 66-SIP Trunk-0-#*.
- To Block Caller ID*
- Dial 66-SIP Trunk-1-#*.

Call Waiting (Note 2, 5)

- To set Call Waiting*
- Dial 72-1-#*.
- To cancel Call Waiting*
- Dial 72-0-#*.

Cancel All Features (Note 2, 5)

- To cancel all features*
- Dial 99-#*.

Notes:

- *Note 1:* The Access Code can be dialed from FXS port, SIP Trunk or Mobile port in dial state. Enter the Index number for the number programmed in the relevant Speed Dial Table for FXS or Mobile port or SIP.
- *Note 2:* You must be in programming mode to issue command.
- *Note 3:* Only Admin can use this command. 'SIP Trunk 1 for SIP1, 2 for SIP2 and 3 for SIP3.
- *Note 4:* Applicable for FXS and Mobile port only.
- *Note 5:* Applicable for calls made from FXS port only.
- *Note 6:* While making calls, to avoid delay of Inter Digit Wait Timer before the SETU ATA211G dials the number, you can dial '#' at the end of dialing all digits of the number.

Other Matrix VoIP Products



SETU ATA2S
VoIP-FXS Adaptor



SAPEX
The All-in-One
Embedded
IP-PBX Server

MATRIX
TELECOM SOLUTIONS
www.matrixtelecom.hu

Magyarországi és Magyar Telekom Ltd. kizárólagos, kizárólagos forgalmazója.
Dellon
1188 Budapest, Mátyás új 24
Telefon: +36 1 210 2111 / 210 2100, fax: +36 1 210 2100
Fax: +36 1 210 2100 / 210 2100, fax: +36 1 210 2100
E-mail: dellon@matrix.hu Web: www.dellon.hu

Version 2, February 2011